

SURFACE TO BE FREE FROM MOULD TOOLING MARKS & TO HAVE A GOOD FINISH

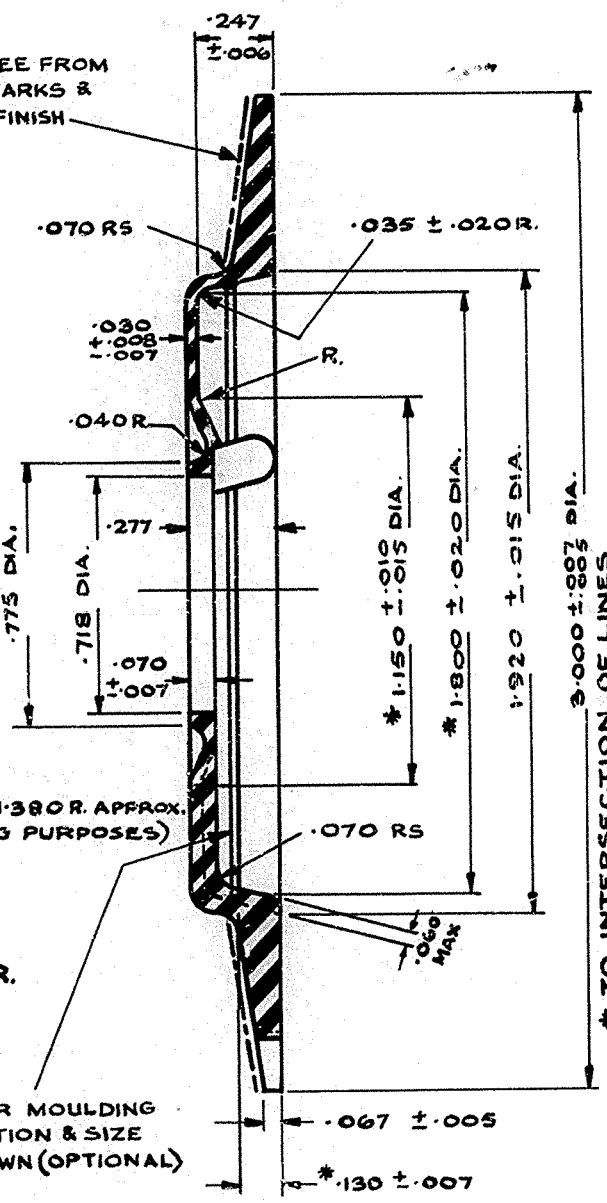

DISTRIBUTION GENERAL	
REFERENCES	
DRGS. SD 64	SPEC. D1000
	SPEC. BS. 381C
	SPEC. BS. 1006
	SPEC. M 291
ASSEMBLY DRG. 90158	WIRING DGM.
FILE 336/11 B.T.T.D.C.	SPEC.
SCALE: - 2/1 AND AS INDICATED	THIRD ANGLE PROJECTION
DECIMAL DIMENSIONS NOT TOLERANCED SUBJECT TO ± .010	
APPD. IN SI SECTION B.F. J.H.C. S.L. HELMAN	DRN. G.E.C. T.C.D. G.E.C. CKD. CONTRS. L.W.M. DATE 15.12.54.

AMENDMENT	SUFFIX
SEE SUPERSEDED ISSUE FOR PREVIOUS AMENDMENTS	
REDRAWN:- NOTE 2 REWRITTEN, FINISH:- REF. TO TYPE OF PAINT DELETED & SPEC. M291 ADDED. CAW J.B. J.P. 12.6.64	E

- NOTES :-
1. A PATTERN OF THIS LABEL MAY BE OBTAINED FOR GUIDANCE UPON APPLICATION.
 2. CLASS NEGATIVES OF DRG. SD 64 (NATURAL SIZE) SHOWING (a) FIGURES AND LETTERS (b) FIGURES ONLY AND (c) LETTERS ONLY ARE AVAILABLE FOR GUIDANCE. REQUESTS SHOULD STATE CODE OF LABEL VIZ. No. 315.
 3. PRINTED CHARACTERS TO SHOW CLEARLY THROUGH RIM OF LABEL.

MATERIAL :- DIAKON "LA" CLEAR.
FINISH :- WHITE PAINT APPLIED ON UNDERSIDE OF LABEL (AFTER PRINTING OF CHARACTERS) WITH PAINT TO SPEC. M 291
FIRST USE :- DIAL, AUTO, No. 13 ... (DRG. 90158)
ALTERNATIVE METHOD OF CONSTRUCTION SEE SHEET 2

C
P. 50784

FOR SUPERSED

LABEL
No. 315