

CALL OFFICE CABINETS.

Arrangement of Equipment for Post payment
Call Office using Box C.C.No.16B complete
and Telephone No. 196 minus Cord.

Magneto System.

Scale 1/8.

OFFICE OF THE ENGINEER-IN-CHIEF, G.P.O.

DIAGRAM E.C. 1586.

Drafted by	Drawn by	Checked by	Engr	Approved by	Date	SUFFIX	
H. X. B.	Horn	W. J. H.	[Signature]	[Signature]	12.1.33		
Amendment Particulars				Initials			
Note added.				[Signature]			21033 A
Layout, rearranged.				[Signature]			1-1-36 B
Equipment details revised				[Signature]		1-1-35 C	

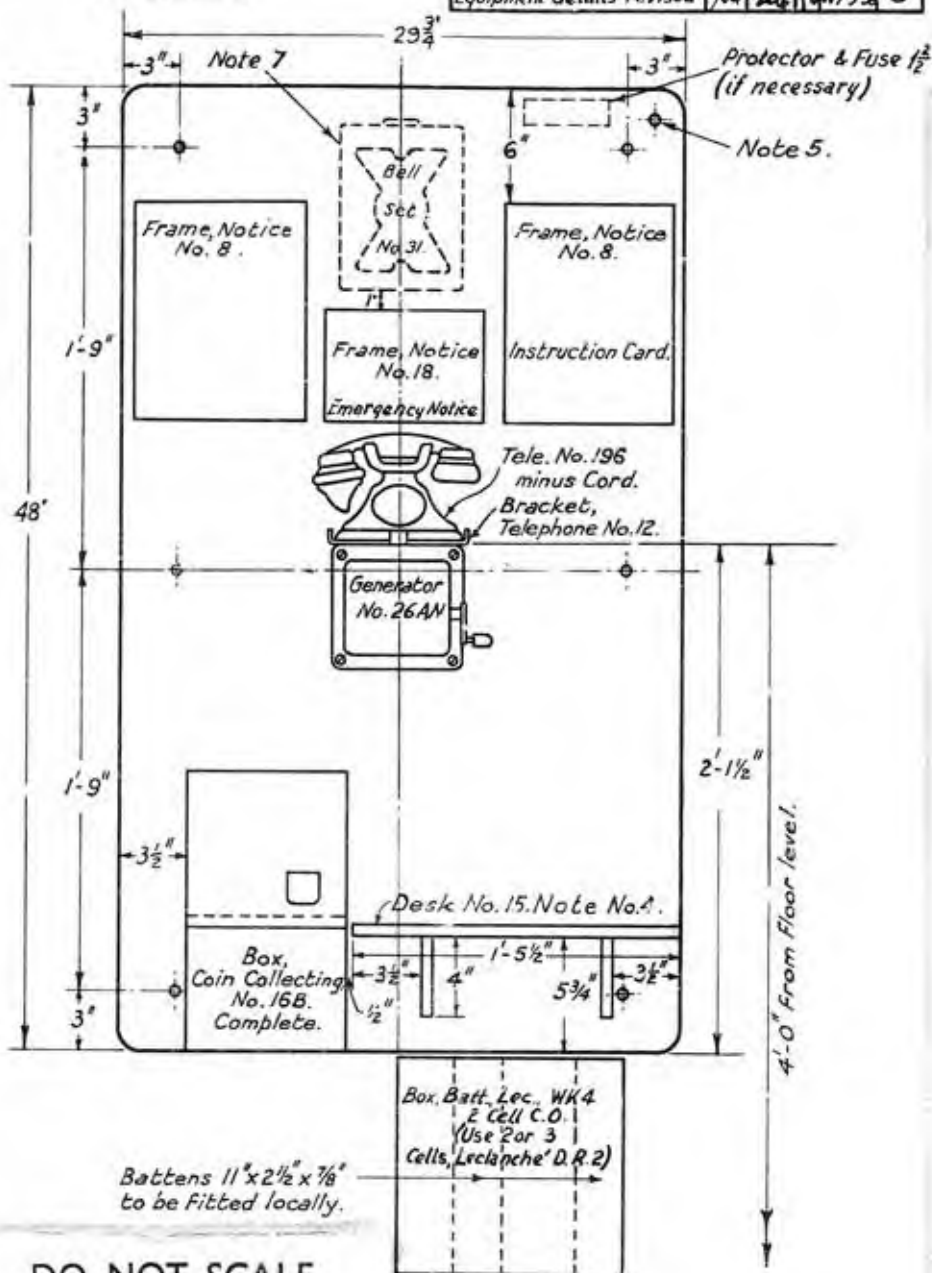

Notes:

DO NOT SCALE
(A MICROFILM PROCESS PRINT)

- No wiring to appear on face of Wallboard
- In non-standard cabinets the layout should conform as nearly as possible to that of the standard cabinet and Wallboard 48"x29 3/4" will be used whenever the width of the cabinet permits. The Wallboard will be mounted centrally between the sides of the cabinet in all cases.
- The bottom edge of Bracket, Telephone No. 12 should be 4'-0" from Floor level.
- The Directory should lie Flat on Desk No. 15; the cord should be passed through hole in desk and fastened to desk bracket.
- In non-standard cabinets where the width does not permit the fitting of Desk No. 15 a Desk No. 17 should be provided, the directory being suspended from a screw-eye fitted at the top right-hand corner of Wallboard.
- The Instruction and Emergency Notice Cards, will be supplied by the T.M. or H.P.M.
- Bellset No. 31 will only be required when the obsolescent "Box C.C.No.16 Complete" is used.