

203

**KIOSKS NO. 6A, B, C OR D**  
**Requisitioning Instructions**

1. **General.** This Instruction explains the procedure for requisitioning complete Kiosks No. 6 and for requisitioning replacement spare parts for repairing damaged Kiosks No. 6. The equipment to be installed in Kiosks No. 6 is described in TELEPHONES, Call Offices, D 3001 and D 3003. A definite date for delivery must be stated on all requisitions and such terms as "early as convenient" and "early as possible" must not be used.

2. **Demands for complete kiosks.** Kiosks No. 6 are supplied in four types, 6A, 6B, 6C and 6D, according to the position of the door and back panel (see Fig. 1). All requisitions must show the appropriate suffix letters of the types required.

3. When the kiosks are to be erected in Scotland, the words "Scottish Crown Required" should be added in the "Remarks" column of the requisition.

4. When a Kiosk No. 6 is required to replace a damaged kiosk the requisition should be marked "Urgently required to replace damaged kiosk". Such demands will be executed immediately.

5. **Replacement parts for Kiosk No. 6.** To satisfy general maintenance requirements the following Rate Book items are available from the Supplies Dept.:-

- (a) Capping, Steel, No. 6
- (b) Disks, Fibre
- (c) Frames, glazing, Nos. 1 and 2
- (d) Glasses, No. 47, 47A, 62A, 62B, 62D and 63
- (e) Handles, Pull, No. 1
- (f) Hinges, Brass, No. 2
- (g) Kit No. 35 - see par. 7 and schedule
- (h) Part No. 1/SPI/169
- (j) Pendant, Brass, P4
- (k) Plates, Mounting, No. 1A
- (l) Pins, Glazing, No. 1A - for Kiosks No. 6 Mk. 2 only
- (m) Shackles, No. 5
- (n) " , No. 6
- (o) Socket, Soldering, Type 1
- (p) Springs, Door Closing, No. 5 LH or RH
- (q) Straps, Restraining, No. 2.

6. **Non-Rate Book parts.** In addition to the Rate Book items referred to in par. 5 the following Non-Rate Book parts may be obtained on requisition from the Supplies Dept., Birmingham Depot for use where complete replacement of a kiosk is unnecessary.

As these items have to be specially manufactured, requisitions may take up to three months to complete.

(a) Doors. Requisitions must state whether right-hand or left-hand. Kiosks No. 6A and 6C have left-hand doors and Kiosks No. 6B and 6D have right-hand doors. The manufacturer's name or code need not be indicated as all doors are supplied slightly oversize and need to be fitted.

- (b) Dome top
- (c) Sill frame
- (d) Side panels
- (e) Back panel
- (f) Front corner pillars
- (g) Rear corner pillars
- (h) Front transom rails
- (j) Rear transom rails
- (k) Side transom rails
- (l) Front crown panels
- (m) Rear crown panels
- (n) Side crown panels
- (o) Crown ornaments

See Notes 1 and 2

See Note 3.

*NOTE 1.* Requisitions must state the type of kiosk for which the part is required, i.e. 6A, 6B, 6C or 6D and, as an additional aid to identification, the section number of the part, e.g. the left-hand rear corner pillar for a Kiosk No. 6A should be described as "Rear Corner Pillar, No. 5 for a Kiosk, No. 6A", (See Fig. 1).

*NOTE 2.* Requisitions must state the manufacturer's name or code letters, e.g. The Carron Co., CC or CCA; The Lion Foundry Co., LF or LFA; Walter Macfarlane & Co., MF or MFA. The manufacturer's name will be found on the outside of the back panel and the code letters on the inside. The code letters will also be found on individual parts of kiosks of recent manufacture.

*NOTE 3.* Crown ornaments are used only on the latest type crown panels with interchangeable ornaments. If the kiosk is in Scotland the requisition should state "Scottish Crown required". Otherwise a St. Edward's Crown will be supplied.

**7.** Kit No. 35 contains all the screws and bolts necessary for the erection of a Kiosk No. 6 and is intended for use where the original supply sent with a kiosk has been lost, or to supply a pool of screws, etc., for kiosk erection parties. The contents of Kit No. 35 are listed below.

No.	Screw size and description. (All have B.S.W. threads and are of steel unless otherwise stated)	Use
4	1/2 in. x 3 in. Conical Hd.	Levelling Screws, [Used with 4 pieces of M.S. Plate, 3 in. x 3 in. x 1/4 in] Corner Pillars to Base
8	3/8 in. x 1 1/8 in. Rd. Hd.	
62	1/2 in. x 1 1/2 in. Rd. Hd.	Door Transom to Corner Pillars Transoms to Corner Pillars Sides to Transoms Sides to Corner Pillars Crown Panels to Corner Pillars Sides to Base
61	5/16 in. x 1 in. Csk. Hd.	
9	3/8 in. x 1 1/2 in. Rd. Hd.	Dome to Crown Panel
8	5/16 in. x 1 in. Rd. Hd.	
1	3/8 in. x 2 in. Hex. Hd. Brass	Earth Bolt - (includes two Washers, Brass, 3/8 in. inside Dia. x 7/8 in. outside Dia.) Used with Socket, Soldering No. 8D
6	1/4 in. x 1/2 in. Csk. Hd. Brass	
15	1/4 in. x 5/8 in. Csk. Hd. Brass	{ 9 for Hinge to Corner Pillar - Long 6 for Shackles, Strap Restraining
2	1/4 in. x 2 in. Csk. Hd. Brass	
4	1/4 in. x 1 1/2 in. Csk. Hd. Brass	Time Switch to Back Panel
8	3/16 in. x 3/16 in. Rd. Hd. Brass	Hardwood Block (E.L. Co's Cut-Out) to Back Panel
4	1/4 in. x 5/8 in. Csk. Hd. Brass	Cable Cleats - Lighting Conduit to Back Panel
8	1/4 in. x 1 in. Rd. Hd. Brass	Door Closer to Transom
3	3/16 in. x 2 in. Rd. Hd. Brass	Wallboard to Back Panel
4	3/16 in. x 5/8 in. Csk. Hd.	E.L. Pendant
7 2	3/16 in. B.S.W., x 2 in. Hex. Hd.	Crown panes to transom
6 1	5/16 in. B.S.W. 2 in. Grub-screw	For fixing Capping Steel, No. 6 to Back Panel
4	Screws, Wood, No. 6, Csk. Hd. Stainless	Slotted one end. To hang Coin-box Container while securing
2	Carriage Bolts, Large Mushroom Hd. 1/2 in. x 1 1/2 in.	Handle, Pull, to Door
6	Screws, Wood, No. 12 1 1/2 in. Brass	Door closer, Door Bracket to Door (includes two Hex. Nuts).
15	" " No. 14, 1 1/2 in. "	Shackles, Strap Restraining to Door
16	Glazing Pins, Brass 1/8 in. x 2 in.	Hinges to Door
4	Pieces M.S. Plate 3 in. x 3 in. x 1/4 in.	Preliminary securing of Glasses No. 47 & 47A
2	Washers, Brass 3/8 in. inside dia. x 7/8 in. outside dia.	Levelling plates for sill
1	Socket, Soldering, No. 8D	

NOTE:- Screws marked 4 can be obtained by local purchase. Those marked 6 are Rate-Book items; otherwise these screws are supplied only as a complete kit under the Rate-Book title "Kit No. 35".

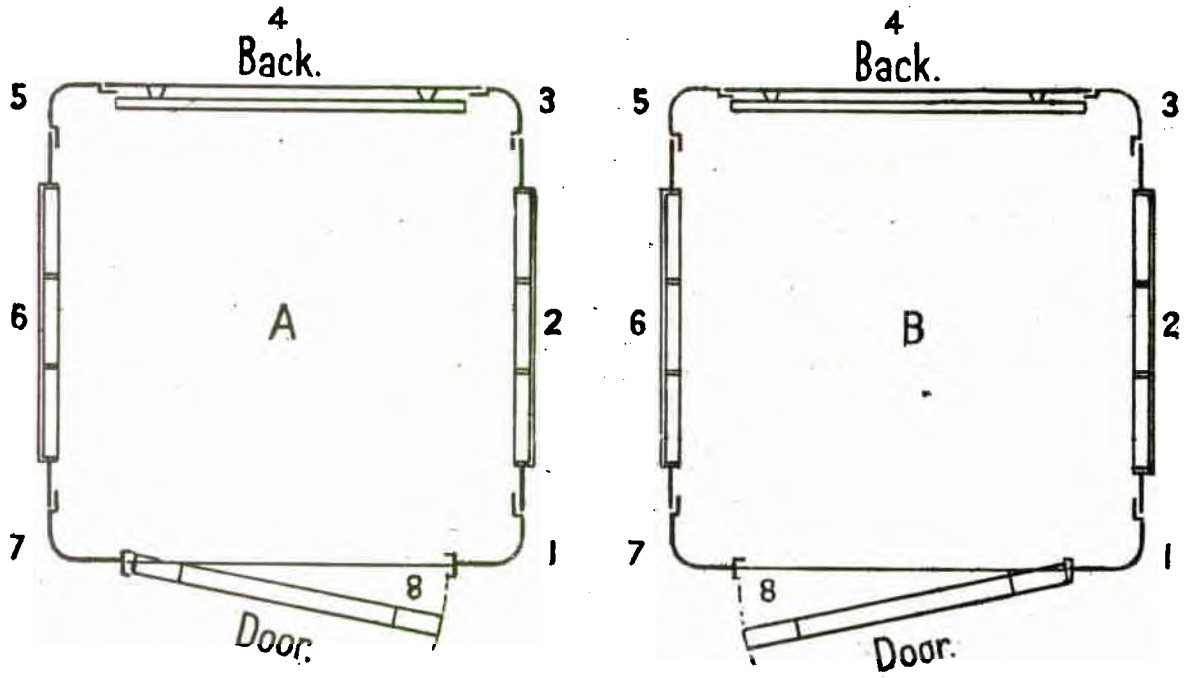

Figures marked all the way up.

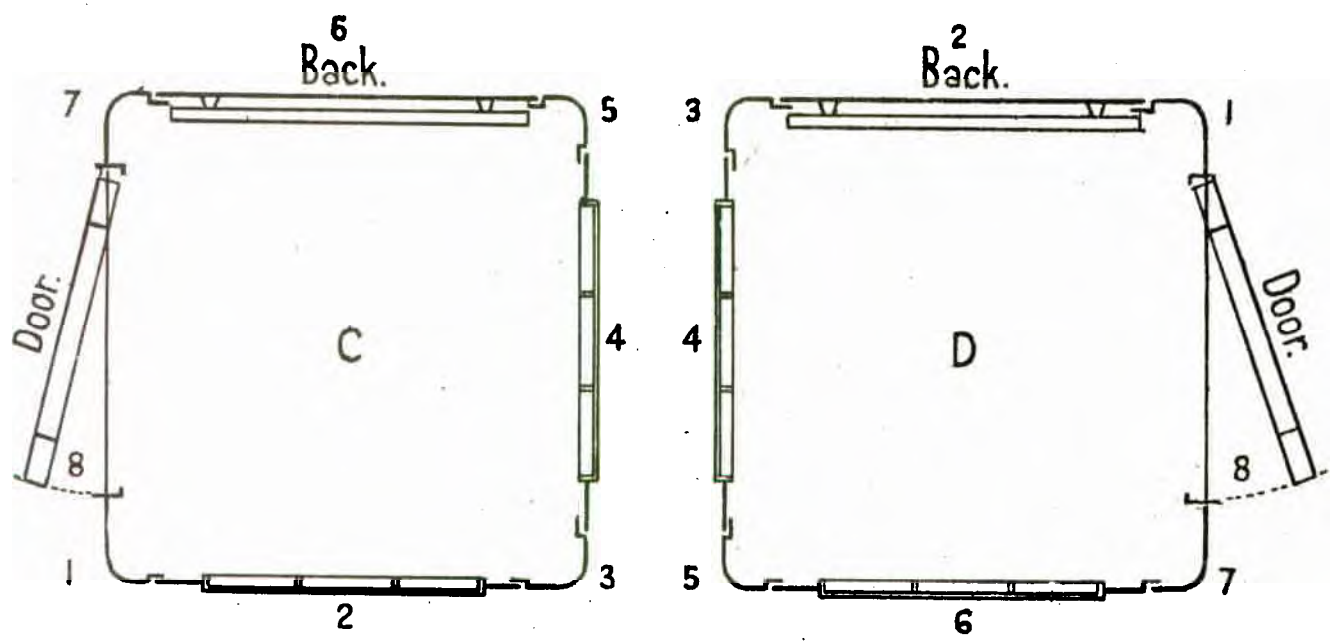

FIG. 1. - "KIOSK No. 6." - SHOWING NUMBERING OF THE VARIOUS SECTIONS

References:- TELEPHONES, Call Offices, C 5904, D 3001, D 3003 (S1/3)

E N D